



Type W

## Installation Notes

- **Installation of Short Standard Wall Sleeves into brickwork or block-work walls.**

Prior to installation identify the inlet face of the Wall Sleeve(s) marked with the "INLET TOP" transfer and ensure that you install from the room at higher pressure.

An aperture should be formed of at least the minimum dimensions (see below) shown in the **Aercon® Type W** brochure for the particular configuration you are installing. (It may be found necessary to provide additional clearance for grouting in purposes)

The Wall Sleeve(s) should now be offered up to the aperture and levelled in both planes prior to final fixing, which can be accomplished by screw fixing using the pre-drilled holes or by drilling and countersinking holes suitable for No. 8 wood screws in the top and bottom plates of the Wall Sleeve(s). It is important that the screw heads do not project more than 2 mm. inside the Wall Sleeve as this may prevent the Valve from being fitted.

**Note** : Drilling of the side plates of the Wall Sleeve(s) is not recommended as this may also interfere with valve installation.

Alternatively Wall Sleeves may be grouted in using mortar.

- **Installing into Plasterboard partitions.**

Cut an aperture as close as possible to the minimum size shown in the brochure (reproduced below)

**50W** - 365 w x 125 h      **50WL** - 504 w x 125 h      **100W** - 365 w x 162 h  
**100WL** - 610 w x 162 h      **200W** - 462w x 264 h

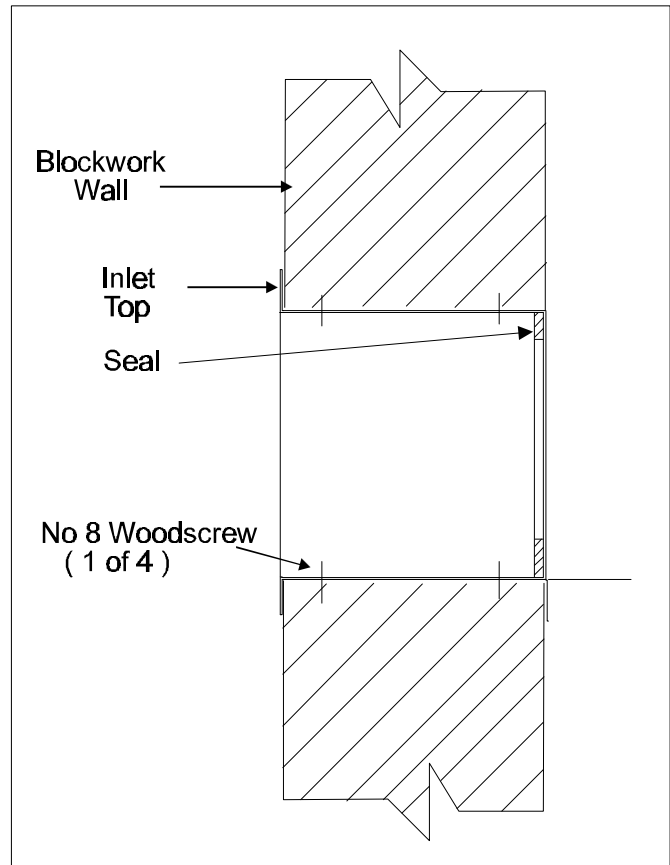

Ensure that the Wall Sleeve(s) is level in both planes and screw fix to the partitioning system using No 8 wood screws through the holes provided. Make good as required.

- **General Notes.**

The wall finish should be applied to the outlet side (low pressure side) face of the Wall Sleeve(s) and may if required be applied to the inlet side as well.

Where multiple arrangements of Wall Sleeves are to be fitted we recommend the use of an overall egg-crate grille on the outlet side (low pressure side) of the sleeves to provide an aesthetically better detail.

- **Installation of Telescopic and Extended Telescopic Wall Sleeves.**

Telescopic Wall Sleeves are delivered in an assembled condition and should be separated into their two halves, prior to fitting, by the removal of the locking screws.

Accurately cut a level aperture of the dimensions indicated in the **Aercon**<sup>®</sup> brochure (see below) and insert one half of the Sleeve from each side of the wall, ensuring that the half marked with the "INLET TOP" transfer is fitted from the high pressure side. Hold both halves firmly against the wall and re-insert the two locking screws into their Hank-nuts and tighten fully. Check that the sleeve is level and adjust if necessary. Seal the internal joint between the two sleeve halves with suitable Silicon mastic.

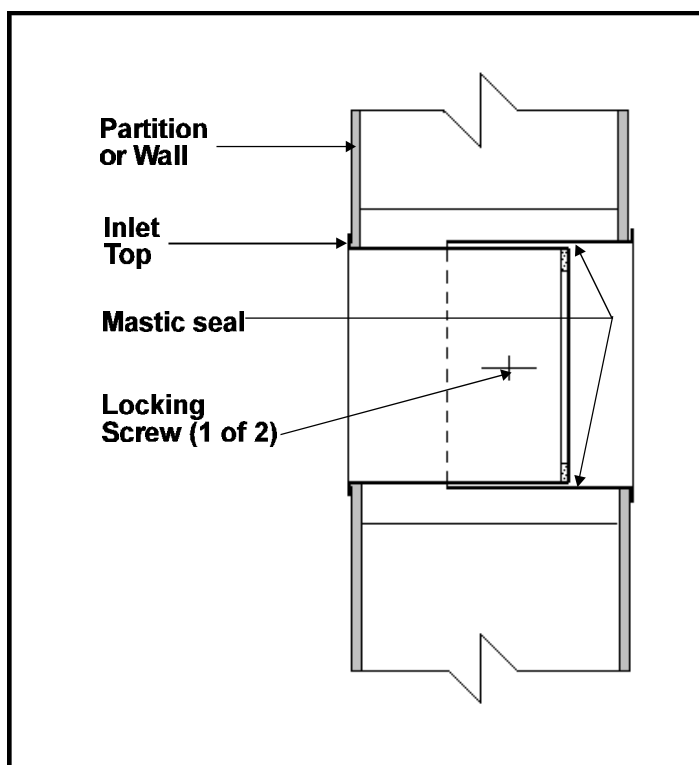

- **Minimum aperture requirements for Telescopic Wall Sleeves**

**50W** - 384 w x 134 h      **50WL** - 384 h x 134 h      **100W** - 384 w x 171 h  
**100WL** - 629 w x 171 h      **200W** 487 w x 274 h.

- **Valve installation - (all applications)**

**Aercon**<sup>®</sup> Type W valves are provided with leaf springs and only require to be pushed into the Wall Sleeve until the rear flange of the valve meets the seal on the inside of the rear flange of the Wall Sleeve.

It is recommended that the front flange of the valve be sealed to the wall using suitable Silicon mastic and that the 3 mm. gap between adjoining valves in multiple arrangements be similarly sealed to prevent the ingress of contaminants.

Where the stabiliser is installed in a location accessible to the public consideration should be given to fitting inlet and/or outlet grilles to avoid trapping/cutting of fingers by the blade(s).

In the event of installation or operational problems, please contact the **Aercon**<sup>®</sup> **Division of Power Utilities Limited** for further assistance.

The policy of **Power Utilities Limited** is one of continuous improvement and we therefore reserve the right to vary specifications without notice.

**Copyright © Power Utilities Limited 2002**

**AERCON**<sup>®</sup>

**Air Pressure Control Valves**

**Manufactured in England by**  
**Power Utilities Limited**



**Established 1934**